

DTS – ELEVATED TAXIWAY EDGE LIGHT

AIRFIELD GROUND LIGHTING SOLUTIONS



LED Omnidirectional Elevated Lights

- TE/E Taxiway Edge

DTS – ELEVATED TAXIWAY EDGE LIGHT



FEATURES

- Specially designed compact structure
- Modulized electrical driver and LED assembly for simplicity of maintenance
- Efficient and stable optical output, suitable for operation with 6.6A and 2.2A CCRs
- Unique optical design, ensuring luminous efficacy and color consistency
- Strict thermal management solution increasing life expectancy
- Highly conductive aluminium mechanical components with special treatment, suitable for various weather conditions
- Precision-cast frangible coupling gives stable and reliable performance
- Built-in surge protection

DTS – ELEVATED TAXIWAY EDGE LIGHT

TECHNICAL DATA



MECHANICAL

- Height
348mm
- Flange Mounting Holes
3 x Ø12



ENVIRONMENTAL

- Operating Temperature
-55°C~+55°C
- Storage Temperature
-55°C~+85°C
- Protection Class
IP55
- Humidity
0~100%



ELECTRICAL

- Connection
FAA L-823
- Rated Input Current
6.6A/2.2A
- Power Factor
> 0.9
- Power Consumption
5VA
- Emission
IEC 61000-6-4
- Immunity
IEC 61000-6-2
- Service Life
LED useful lamp life > 80000h



DTS – ELEVATED TAXIWAY EDGE LIGHT

DIMENSIONS



COMPONENTS

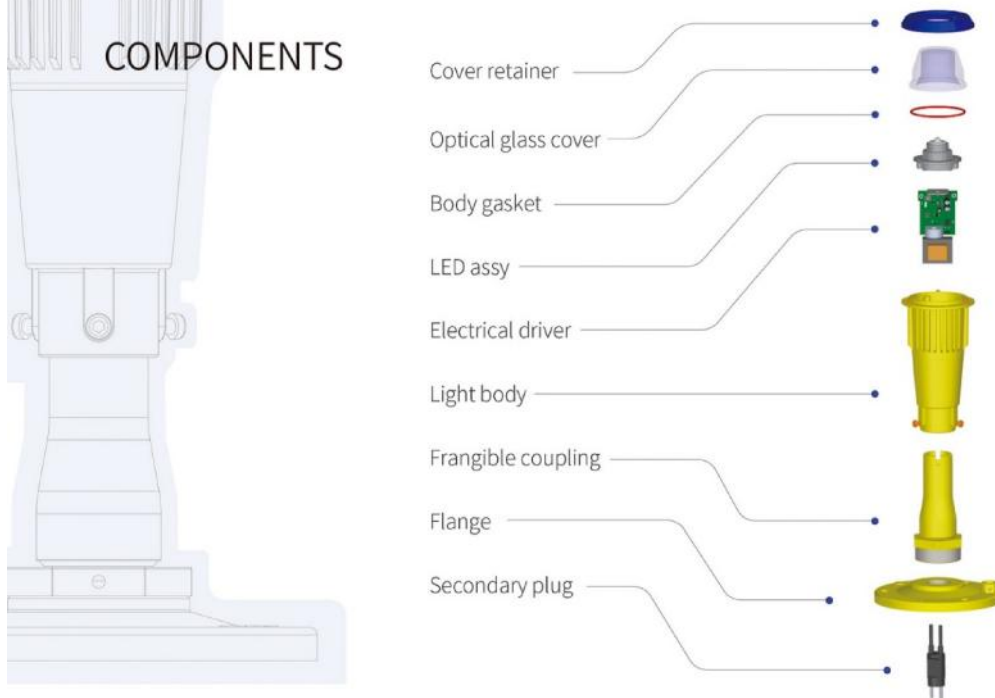

ACCESSORIES

- Flange (168mm OD)
- Flange (300mm OD)
- 2-1 inches 11 TPI frangible coupling
- L-823 receptacle

PACKAGE



Dimensions (2 pack): 300mm (L) X 243mm (W) X 115mm (H)

Net Weight: 1.2kg Gross Weight: 2.6kg

* Packaging is subject to upgradation. Above data are reference values.

DTS – ELEVATED TAXIWAY EDGE LIGHT

CHROMATICITY

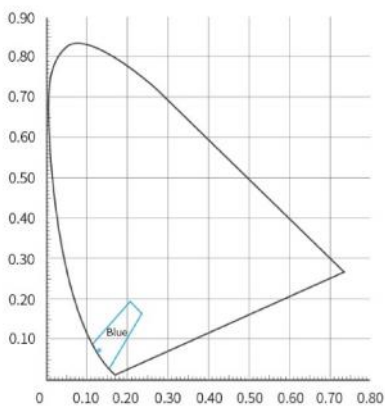

PHOTOMETRICS

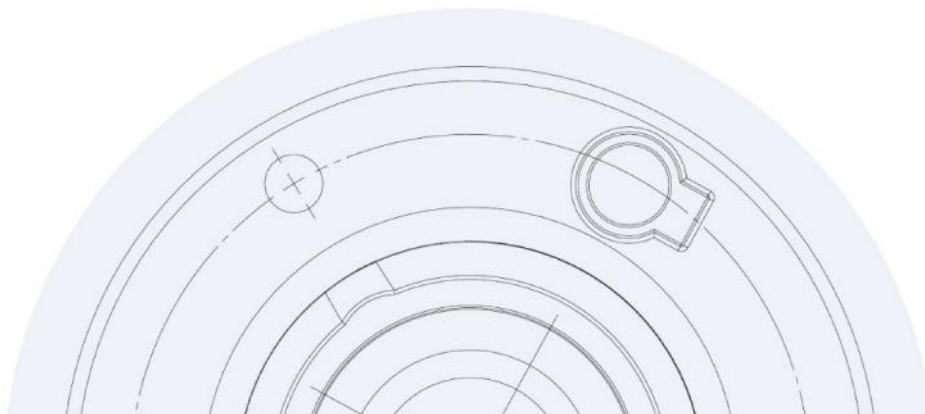
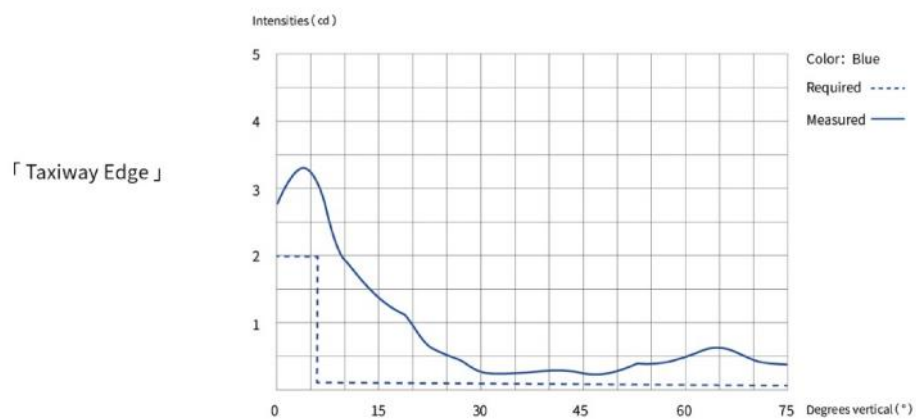

DTS – ELEVATED TAXIWAY EDGE LIGHT

ORDERING CODES

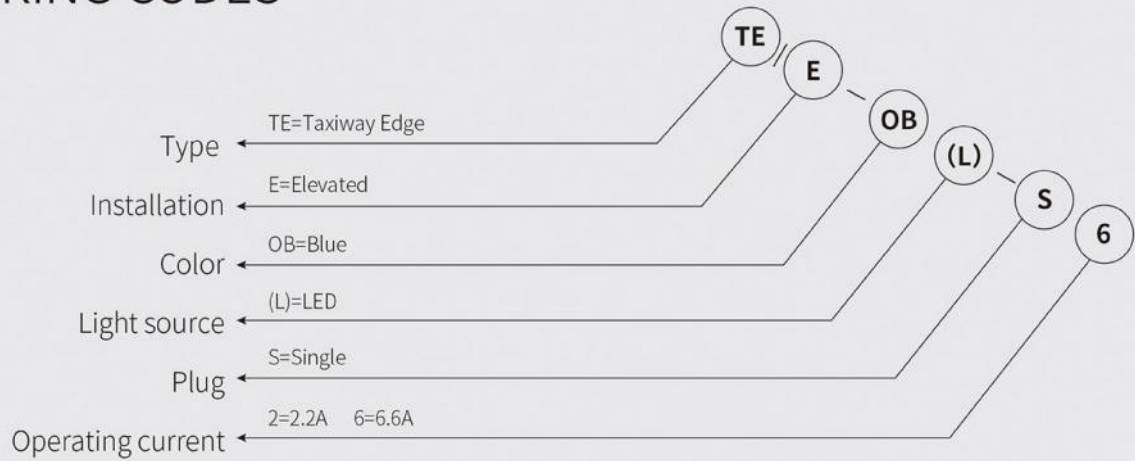

★ Accessories should be ordered separately